

# Bergeron Dental Clinic

Combining high-end design, acoustic optimization, and spatial fluidity

**CLIENT**  
Bergeron Dental Clinic

**TEAM**  
Groupe Patriarche :  
Patriarche (Architecture, Interior Design, Signage)  
Partners :  
Odacy Construction | General Contractor  
Henry Schein | Dental Equipment  
Montréal Acoustique | Acoustic Panels  
Compo Orléans | Signage Printing

First renovated in 2015, the Bergeron Dental Clinic continues to grow and sought to redesign its spaces to support its expansion. The goal: to add eight new treatment rooms, a dental technology laboratory, and new offices, while optimizing the existing spaces.

This redesign made it possible to adapt the space to the team's evolving needs, notably by adding secretary workstations and re-thinking employee areas, while also enhancing the client experience — already a core priority for the clinic.

We also took the opportunity to update certain existing rooms by maximizing their functionality and replacing worn elements, in order to ensure the durability and overall quality of the environment. All of this was achieved without interrupting the clinic's operations during the renovation, thanks to meticulous planning.

|                       |                            |                             |
|-----------------------|----------------------------|-----------------------------|
| Typology<br>Expansion | Construction cost<br>N/A   | Status<br>Delivered in 2023 |
| Area<br>658 m²        | Location<br>Quebec, Canada |                             |



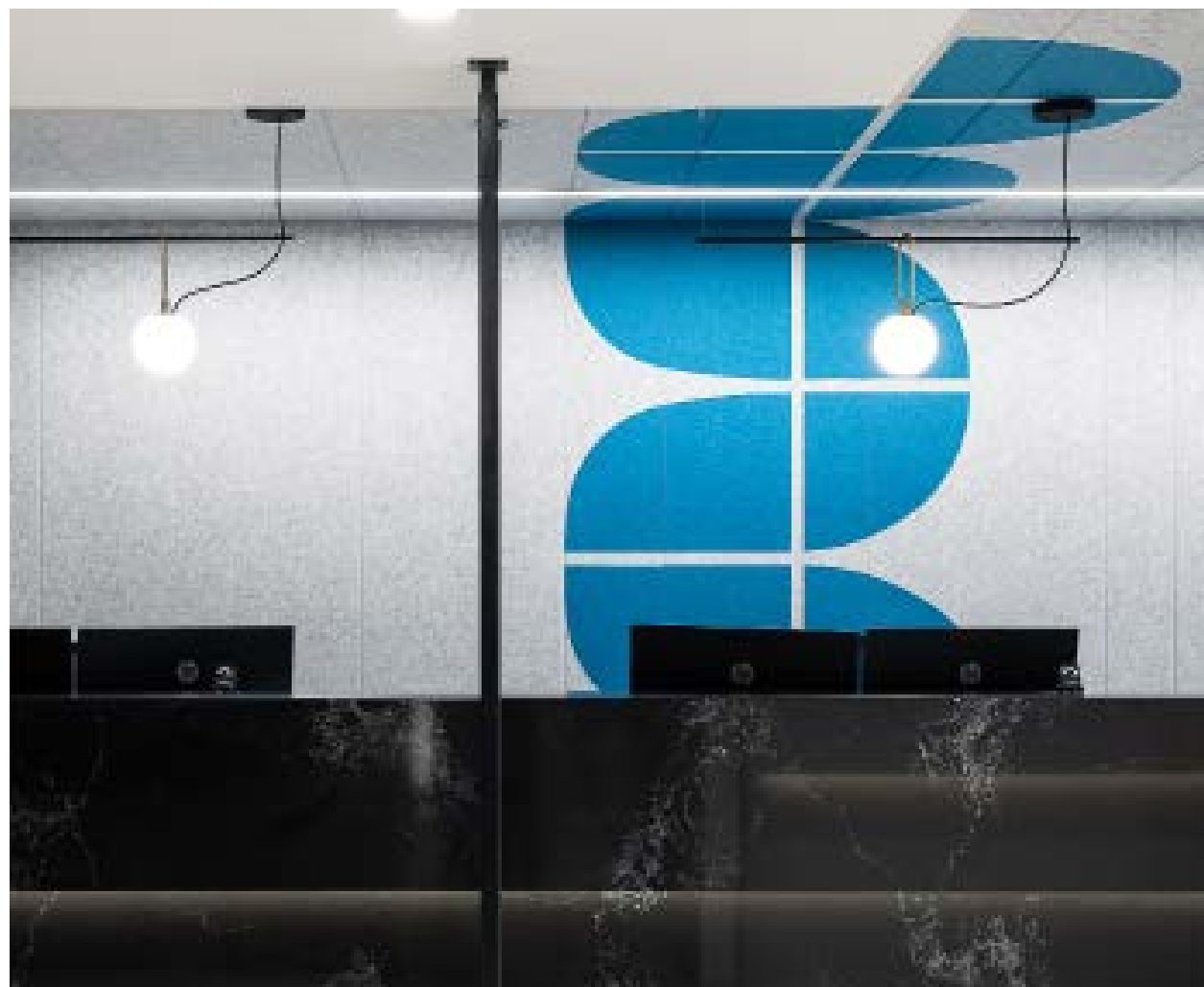

## Reconciling the existing with the new

One of the guiding principles of the project was the desire to respect the existing structure while introducing a breath of fresh air. The 2015 renovations had been carried out using materials that were still in excellent condition. Rather than starting from scratch, we chose to reuse several elements: furniture, dental equipment, and glass partitions. This decision helped reduce costs and represented a responsible environmental gesture.

The junction between the old and the new was carefully considered down to the smallest detail.

The choice of materials and tones allowed for a smooth transition between areas, without disrupting the overall ambiance. Contemporary elements were added — built-in furniture, lighting fixtures, textures, and signage — to modernize the space and evolve the clinic's image.

The goal : to add eight new treatment rooms, a dental technology laboratory, and new offices, while optimizing the existing spaces.





## A high-end, understated, and contemporary ambiance

---

The client wanted an atmosphere that was both refined, elegant, and enduring.

The architectural concept was built around a sophisticated palette combining black quartz, dark wood, natural stone, and textiles in warm tones, to soften the space and make it more welcoming. These materials were chosen for their timelessness and ease of maintenance, while also evoking a high-end clinical environment. The blue from the logo was subtly incorporated into the project, behind the reception desks, adding a distinctive touch of identity.

The blue from the logo was subtly incorporated into the project, behind the reception desks, adding a distinctive touch of identity.

In the secretaries' area, seven workstations are arranged on either side of a central space — with dark counters on one side and white counters on the other.

This simple yet well-balanced contrast energizes the space while subtly structuring the work zones. Carefully selected decorative lighting softens the ambiance, especially in the waiting room. Far from the cold stereotype of dental clinics, this reception area evokes a cozy, comfortable, and reassuring lounge.



# Acoustics redesigned for greater comfort



Acoustics were a major challenge from the outset. Although the clinic is located on the third floor, vibrations and noise from its mechanical room on the ground floor were causing disturbances to neighboring tenants. At the landlord's request, we conducted a detailed acoustic analysis to identify the sources of nuisance and implement targeted corrective solutions, restoring a peaceful environment for all building occupants.

Inside the clinic itself, the sound environment received special attention. In the open area for secretaries, acoustic panels were installed between each workstation to reduce ambient noise and provide greater privacy during interactions with patients.

The choice of materials was guided by the hygiene requirements specific to healthcare environments, notably the use of glass and ceramic, which are easy to maintain but offer limited acoustic performance. To compensate for this, we designed soft alcoves for the secretaries' workstations and integrated an absorbent-textured carpet in the waiting room.

The layout was also designed to clearly distinguish active zones (reception, circulation) from quieter areas (waiting, treatment). Additional acoustic treatments in the corridors and waiting room helped reduce footstep noise and conversations, contributing to a calm and professional atmosphere.

# Ergonomics and efficiency: a clinic designed for people

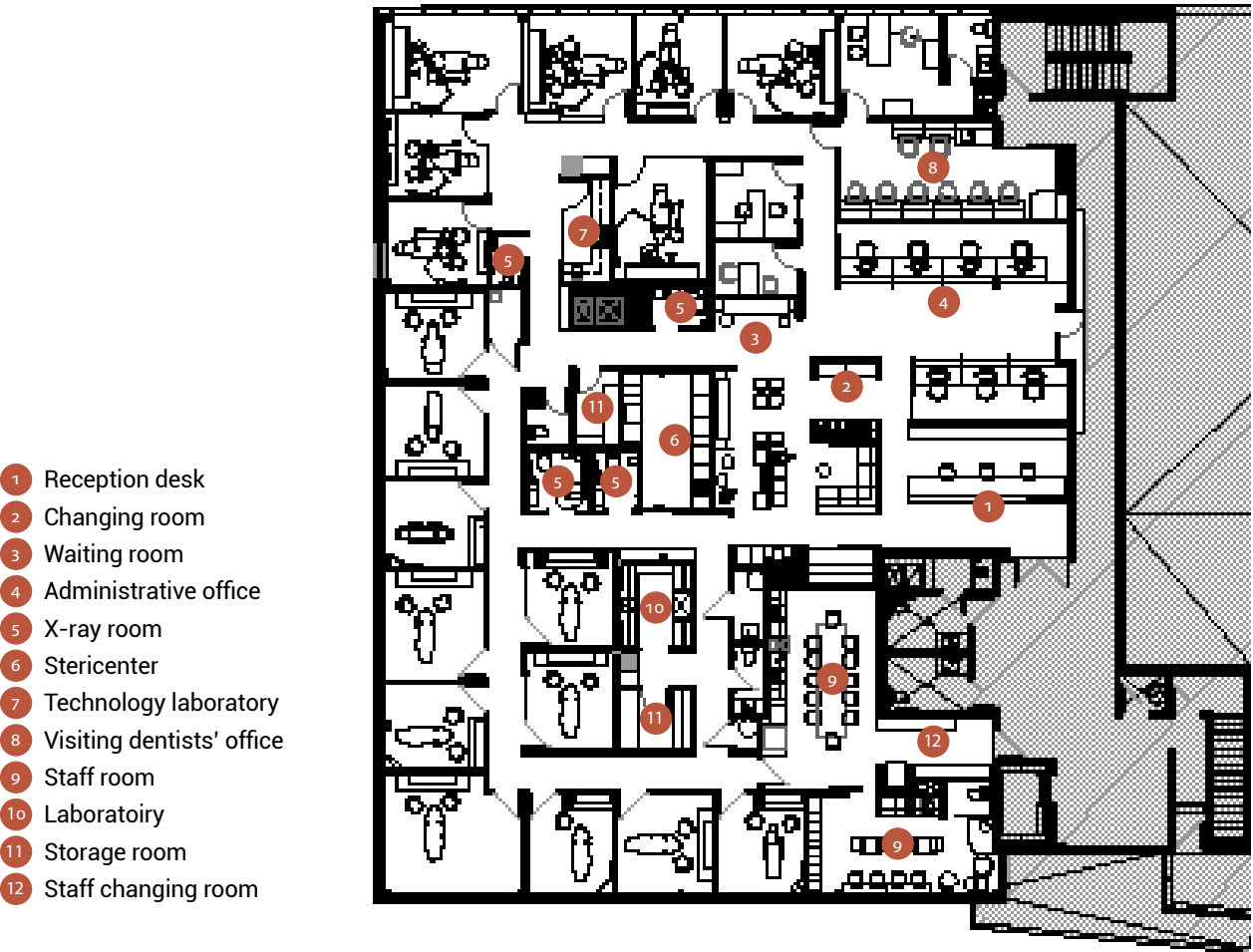

Before the renovation, the lack of space limited the team's performance. Some employees had to work in cramped areas with few storage options. The new layout completely changed the situation. Each secretary now has an elevated workstation, installed on a podium, allowing for a comfortable seated posture while maintaining eye-level contact with patients at reception — avoiding tension and discomfort.

The design also helped clarify the function of each space: Public areas and staff-only zones were redefined to improve circulation and increase efficiency. Storage placement was optimized based on proximity to tasks.

The patient's journey through the clinic was given special attention. From the moment they enter, the path is logical and intuitive: reception, cloakroom, waiting room, treatment room — strategically passing by the laboratory to highlight the clinic's professionalism — and finally returning to the payment area, positioned near the exit. This smooth flow adapts to all seasons, without confusion.





## Signage and lighting: subtlety and orientation

Circulation within the clinic was also improved thanks to discreet yet effective signage. Frosted films and window decals were applied to doors and glass surfaces, preserving privacy without blocking natural light. These graphic interventions also served as visual markers to guide visitors and structure the spaces.

Lighting was also redesigned. Some corridors suffered from insufficient brightness. We collaborated with a specialist to conduct a photometric analysis and adjust light levels according to usage, ensuring a smooth transition between circulation areas, treatment rooms, and workstations.

## A worksite with uninterrupted operations

One of the most critical challenges of the project was the need to maintain the clinic's services throughout the entire duration of the work. A tightly planned schedule, divided into three phases, made it possible to meet this requirement. The interventions were carefully coordinated to minimize disruptions and ensure that the clinic's operations were never compromised.





# Bergeron Dental Clinic

|           |                   |                   |
|-----------|-------------------|-------------------|
| Typology  | Construction cost | Status            |
| Expansion | N/A               | Delivered in 2023 |
| Area      | Location          |                   |
| 658 m²    | Quebec, Canada    |                   |