

# CHOR 2

Elevation and construction of a building to accommodate an outpatient consultation service, a day hospital, a dialysis unit, medical control rooms, and a 60-bed unit.

CLIENT

Centre Hospitalier Ouest Réunion (CHOR)

TEAM

Autumn | Patriarche (General Contractor, Lead Consultant)  
Patriarche (Architecture, Interior Design, External Works, BIM, Narrative Design)  
OBA (Local Architecture)  
Partners : EMCI (Structural Engineering), INSET (MEP/Fire Safety/Thermal Engineering), RESILIENS (Environmental Quality), REEC (Cost Consulting), AD HOC (Landscape Design), VIVIE (Acoustics), CIR&KOUR (Kitchen Design), GANDEMÉR (Air Handling), 8'18 (Lighting Design), Walter | Patriarche (Operations & Maintenance), and Setec Organisation (Project Management Assistance).  
Credits :  
3D renderings : ©Jeudi Wang

KEYPOINTS

Attention Architecture.  
Extension.  
Vertical Extension.  
Simple Construction Methods.

ENVIRONMENTAL PERFORMANCE

Bioclimatic Design.  
Bio-based Materials.  
Greening of Surrounding Areas.

On a steeply sloping site located in the northwest of the city of Saint-Paul on Réunion Island stands the Centre Hospitalier Ouest Réunion (CHOR). This local healthcare facility meets the needs of a growing population of 215,000 inhabitants.

To expand its healthcare services and increase its capacity, CHOR is adding a new building and elevating one of its existing structures. Integrating into the existing urban fabric requires a response that anticipates needs in terms of mobility, transformation, and adaptability.

Through a sustainable and flexible project, the future infrastructure will ensure optimal and efficient patient care.

CHOR 2 notably includes the elevation of the South Wing to add 60 additional beds, the construction of a building housing a day hospital with 44 outpatient places (including 16 for chemotherapy), a dialysis center with 26 stations, 6 additional consultation rooms, a tertiary floor, a medical-technical area, and two levels of parking.

The project thus proposes a contextual architecture that interacts with the built and natural environment of the site. Like the existing CHOR, the extension project reflects the same commitment to developing a bioclimatic architecture guided by wind patterns.



Typology	Construction cost	Status
Healthcare	29,5 M€	In Progress
GFA	Location	Type of contract
7 600 m²	Saint-Paul, France	CCAEM



# Site Integration and Bioclimatic Design

The CHOR extension project is truly an urban project.

Beyond a fixed response to immediate needs, the project aims to create flexible frameworks and “cultivate” principles that will allow for future evolutions and expansions of the hospital site.

The CHOR2 building is thus located in close proximity to the existing structure at ground level. This level forms the true heart of the site, where the landscape serves as the central element welcoming patients and visitors. By positioning itself at the same public level as the existing facility, it integrates seamlessly into the site's urban fabric, continuing the existing interactions.

A contextual architecture that engages with the existing and the already-there, the project interacts with the built and natural environment of the site, building in harmony with airflows to enable natural ventilation.

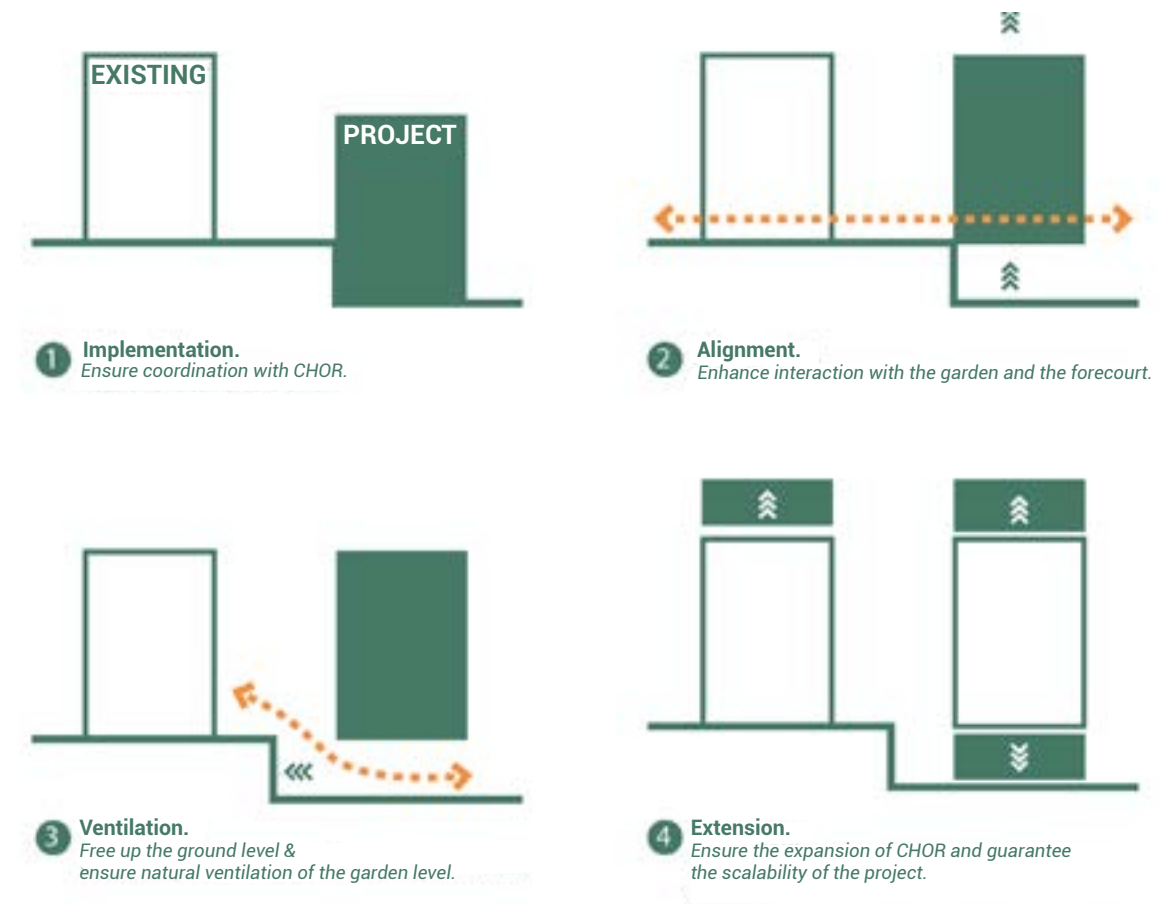

## Bioclimatic Design

The architectural climate-conscious design of the extension project was considered not only as a whole and within its built environmental context, but also in relation to the evolution of the immediate existing structures. It ensures that its presence does not compromise the natural ventilation system of the current building.

The project proposes a responsible thermal design, with a particular focus on efficient natural ventilation, despite relatively mild wind conditions. The proposed architecture, dedicated to natural airflow, avoids the effects of obstructions, turbulence, and interactions caused by the existing buildings on the site (CHOR1). Furthermore, the project's climate-responsive architecture inherently includes the potential for adaptation and preservation of the implemented ventilation principles in the event of future extensions or vertical additions.





# Places for meeting and exchange

To propose an architecture of care that reconnects with all sensitive bonds, restoring our presence in the world, our capacity to feel and to act — for both patients and caregivers.

## The Landscape

The landscaping approach is based on respecting the spirit of the existing park, a true source of coolness. Inspired by the layout of English gardens, the project continues to trace winding paths, thus extending the softness of the existing lines. In this pursuit of harmony, large mature trees are preserved to support biodiversity and the existing plant heritage.

Organized around planted spaces, CHOR maintains a privileged relationship with its natural environment. The hospital's permeability to the city is accompanied by an increased presence of landscape, helping to combat soil artificialization and urban heat islands.

The garden, visible from within the building, invites an intimate dialogue with nature. The organic integration of vegetation into the architecture is expressed through patios and rooftop gardens. Vines create a direct link between humans and plants, uniting interior and exterior spaces.

This presence of greenery is also a source of calm and well-being within the hospital.

## The Architecture of Attention

The project restores attention to others and to the world, placing intention on the therapeutic qualities of the landscape. It offers a familiar architecture in which everyone can find themselves. Each visual opening is conceived as a moment of rest for both body and mind.

Through its spatial and sensory qualities, the architecture supports the patient throughout their care journey, helping them to face the challenge of illness and to take care of themselves.







# CHOR 2

Typology	Construction cost	Status
Healthcare	29,5 M€	In Progress
GFA	Location	Type of contract
7 600 m²	Saint-Paul, France	CCAEM