

École Val des Roses

Unify the image of the school complex through energy renovation, regulatory compliance, and the construction of a wooden extension.

CLIENT

Ville d'Albertville

TEAM

Patriarche (Architecture, All-trades Engineering, Cost Management, Interior Architecture, Landscape, Environmental Quality, BIM)
Autumn | Patriarche (General Contractor / Design-Build Contractor)
Patriarche Creative (Graphic Design, Signage, Communication)
Partners: Gustave (Timber Engineering), Climater, ABC Decibel

KEYPOINTS

Timber construction.
Reconfigure circulation flows.
Functional layout.

ENVIRONMENTAL PERFORMANCE

BBC renovation.
E2C1-level extensions under the E+C- label.
Low-carbon materials and bio-based insulation
Urban heat island reduction: greening and vegetation.

The school is located in the Val des Roses neighborhood, an area undergoing an urban renewal project aimed at strengthening social cohesion, renovating surrounding infrastructure (buildings, road networks, etc.), and boosting the local economy.

Originally built in the late 1950s, the school has undergone several transformations up until 1990. These different construction phases are quite visible throughout the building, with highly contrasting architectural styles.

This project presents an opportunity to unify the architectural identity of the school complex and to give it a cohesive, welcoming, and attractive image.

It is also a chance to improve the building's functionality by simplifying circulation flows, ensuring regulatory compliance, and achieving high energy performance while reducing its carbon footprint.

The choice of timber construction, beyond the warm atmosphere it creates, will contribute to an excellent carbon balance and demonstrate a strong environmental commitment.

Our proposal is accompanied by an action and information plan, as well as a communication strategy to support the school in announcing its transformation..



Typology Education, Renovation	Construction cost 6.5 M€	Status Delivered 2025
Area 3 500 m²	Location Albertville, France	Project delivery Design & Build

Intent – Design Choices

The existing school is completely reimagined. New buildings are constructed, and the existing structures are renovated. Work on the building envelope, featuring timber cladding, transforms the school's image while meeting energy performance requirements.

With its new layout, the school opens up to the city, creating a vibrant area alongside the market square, the park, and the church.

A welcoming, transparent volume facing the square houses the main entrance of the school complex, along with a library distinguished by a rhythmic arrangement of wooden columns.

The reading of the different volumes is simplified, and circulation flows are reconfigured to accommodate the growing number of students.

Increase capacity, manage circulation flows, and bring coherence.

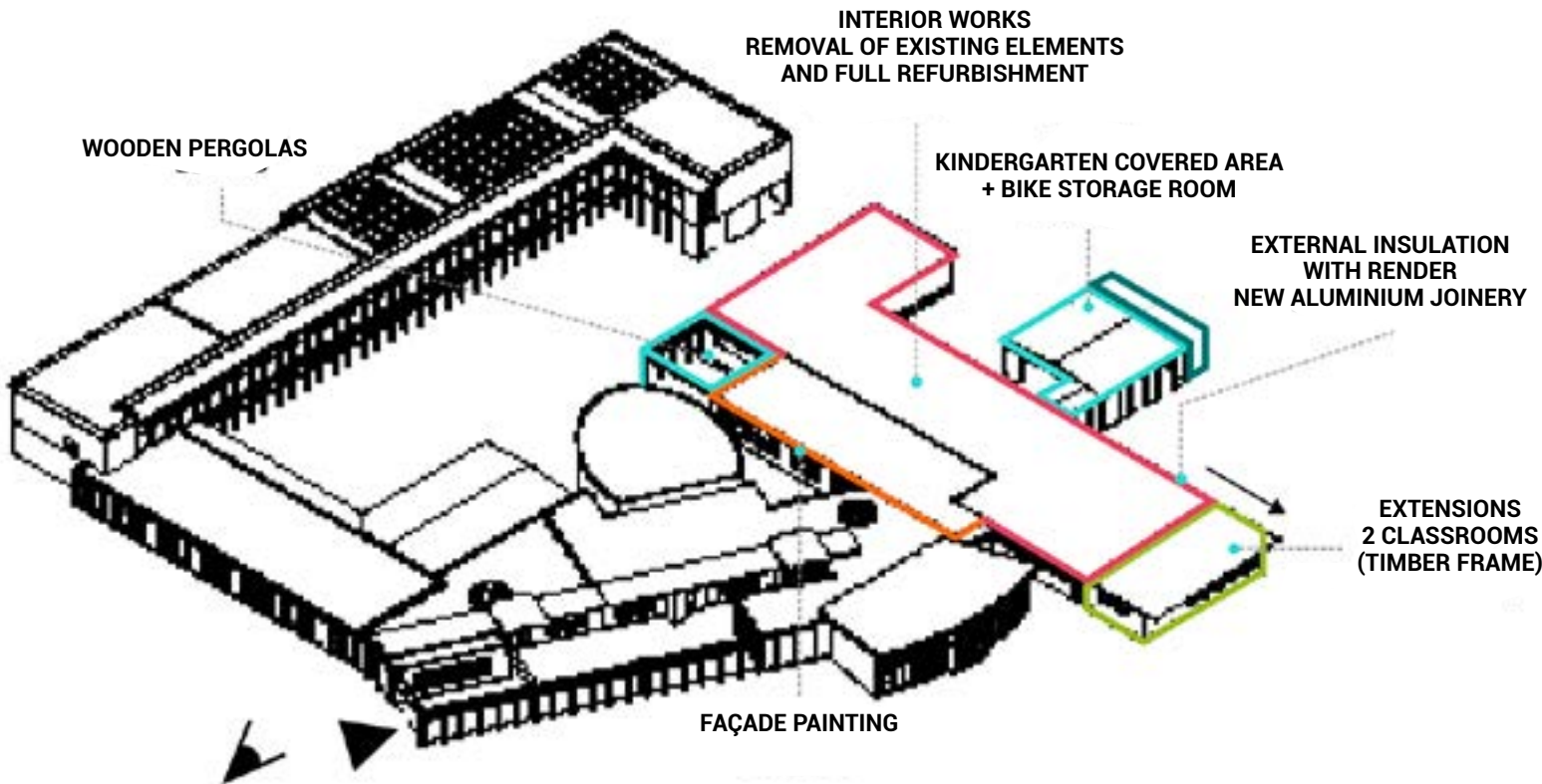

Spatial reconfiguration of the playgrounds

The current challenge is to refocus playground design around children's well-being. The goal is to reinvent this space as a more welcoming environment where every child can find their place. Vegetation plays a key role—as a calming natural element, a spatial organizer, and a pedagogical tool. In each of the two playgrounds, the different zones are clearly defined: the covered area, the garden, the play area, and the “refuges.”



École Val des Roses

Typology
Education, Renovation

Area
3 500 m²

Construction cost
6.5 M€

Location
Albertville, France

Status
Delivered 2025

Project delivery
Design & Build