

Orange Guinea Headquarter

Construction of the new ORANGE headquarter in Guinea, an evolving building for an evolving company.

CLIENT

Orange

Located in the heart of the growing Koloma office district, the project aims to transform the site into an epicentre of Orange's influence.

TEAM

Patriarche (Architecture, Cost)
Partners :
Tas International, Projex Group

The challenge of this project was to design an emblematic, qualitative and unique architecture while respecting the social and environmental issues present in Guinea.

KEYPOINTS

Flexible offices.
Conference room.
Covered parking.

The project consists of reception areas, a conference room, a company restaurant, a sports hall and fully flexible office space.

The general volumetry consists of two wings connected by a central part. A series of external walkways reinforce the link between the two built volumes. In the centre, a shaded patio is accessible at all levels via various pathways: walkways, terraces and footbridges.

Typology
Offices

Construction cost
N/C

Status
Delivery 2024

Surface
18 000 m²

Location
Conakry, Guinée

Type of contract
Private



Intentions

The architectural design focuses on the qualitative landscaping of the entire site, elegant architecture, a volumetry at the service of the work spaces, total flexibility of the office floors, solar protection of the interior spaces.

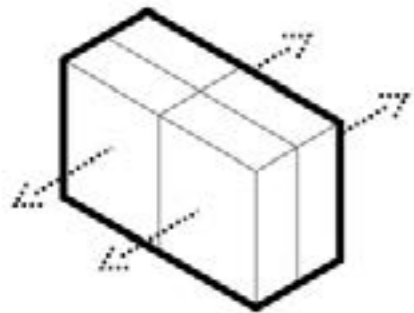

Workspaces

The central part of the project houses the main core within which the vertical circulations, technical spaces, sanitary blocks and all the common spaces are articulated; lounge-café area, reprography, archives, large meeting rooms.

The external walkways form a real link and facilitate movement between the two wings of the building. They are present on all floors.

Footbridges located at the end of the wings reinforce the connection between each part of the building. Present on every other level, they give shape to an inhabited patio creating a dynamic in use and in the aesthetics they bring to the project.

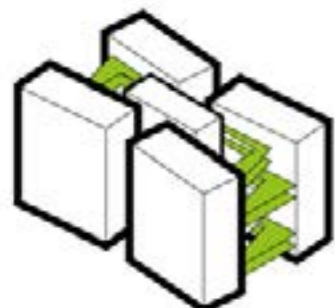
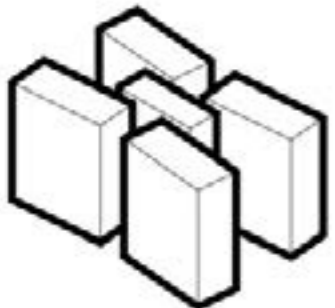
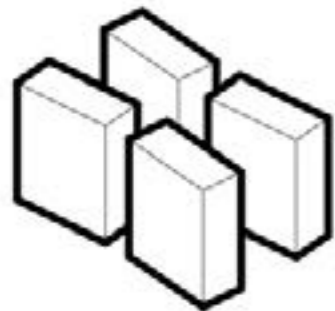

Office space

The floors offer flexibility and total freedom of the different spaces they offer. Benefiting from first daylight, the organisational scheme defined by the architectural concept is simple and effective. The open spaces, such as communal areas, are distributed throughout the interior of the wing, with direct access to the corridors. The more partitioned spaces, such as the meeting rooms, are distributed on the fringe of the outer wings. This distribution makes it possible to maintain maximum flexibility in the communal areas, as the partitioning can be changed as needs change.

Landscape

On the scale of the building as well as on the scale of the site, a real place is given to green spaces and vegetation.

Vegetation is thus present all around the site and on the building at several scales.

Planted strips form a green belt at the foot of the indoor and outdoor parking levels. These green areas provide shade for the entire above-ground parking area.



Restaurant

The company restaurant communicates with the other departments on the ground floor. It offers a largely green outdoor space. The restaurant is organised in a functional way to facilitate its use, an essential dimension of this central place in the life of the site.

The different spaces are arranged so that the flows are as optimised as possible and no crossing is necessary between the user path and the technical flows.

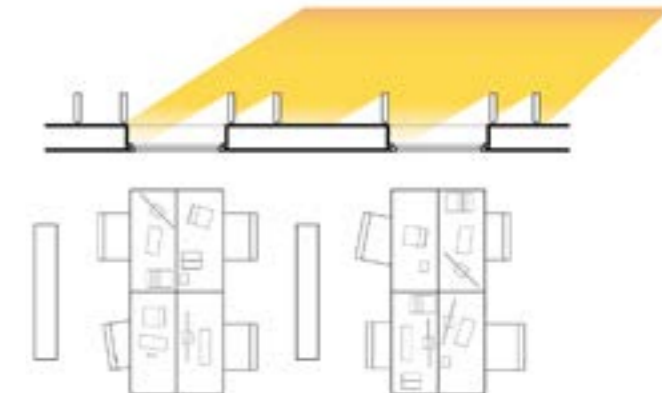

The facades

A sober, raw and elegant first concrete skin is completed by a second «filtering» skin. The facades are composed of fixed metallic vertical slats in a pastel gold colour, giving the project a fine and accurate colorimetry in a context of glowing tones. The particularity and the major asset of this system lie in its efficiency in dealing with daily solar gains. They are positioned at a 90° angle to the facade to protect against almost all direct sunlight.

A significant plant presence

The base

First and foremost, the project must be anchored in the ground, like a tree with its roots. This principle is embodied in the base of the building, occupied by two levels of parking, surrounded by densely planted buttresses. The planting creates a landscape that can be appreciated from the street. The planting creates a landscape that can be appreciated from the street. It is composed of several levels, low vegetation of ground cover and low plants, banana trees and medium-sized trees and a few large trees.

The role of vegetation in towns and cities, particularly in hot climates, is vital for regulating heat, improving air quality and enhancing the well-being of residents.



The flow

The base is intersected by a fault that brings the building into contact with the ground around its entire perimeter, opening up the two levels of car park to a garden. At ground level, it is planted like an undergrowth with tropical flowering plants and tree ferns that give it a soothing atmosphere, while very large, fast-growing trees emerge from the forecourt slab and confront the scale of the building. The ten or so Eucalyptus deglupta or Rainbow-gum trees have very slender trunks whose coppery bark peels away to reveal shades of colour like flames and light foliage. So when you walk through this gap, you benefit from an influx of natural light, while being protected by a canopy that reduces the height of the building above.

The hanging gardens

The verticality of the architectural design is reflected in the landscape through the creation of hanging gardens on the terraces. They are a source of wellbeing for the people who work there, providing a planted foreground as well as places to relax as an extension of the communal areas. The gardens are designed as pieces of natural landscape suspended between the earth and the sky. The plants are chosen for their ability to adapt to growing above ground and being exposed to the wind: palm trees, bamboo and tropical flowering plants.





Orange Guinea Headquarter

Typology
Offices

Surface
18 000 m²

Construction cost
N/C

Location
Conakry, Guinée

Status
Delivery 2024

Type of contract
Private
