

EPSM

Construction of the Chablais child psychiatry center in Thonon-les-Bains.

CLIENT

EPSM 74

TEAM

Patriarche (Architecture, Interior Architecture, MEP Engineering, EBQ, Cost, BIM, Landscape, Narrative Design, Signage, Graphic Design)

Partners:

Venathec, ATGT

Credits:

© Patriarche

KEYPOINTS

Well-being and safety.
Flow management.

SUSTAINABILITY

Renewable energy management, bioclimatic and low-carbon design.

The project to build the future Chablais child psychiatry center has a bold ambition: to be a facility that takes care of its patients and staff, while at the same time being a high-performance work tool and a secure, fulfilling place to be.

Located at the gateway to the town of Thonon-les-Bains, the project pays particular attention to sustaining a warm and welcoming landscape atmosphere.

Due to its geographical location, the site unfolds around natural and urban constraints. To provide a reassuring setting for patients, the main facade protects the two day hospital courtyards on the first floor. The building is designed in a comb shape, so that the day units wrap around their respective courtyards, offering a solid framework, a protective, containing envelope.



Typology	Construction cost	Status
Health	5.7 M€	On going
GFA	Location	Mode of assignment
2 172 m²	Thonon-les-bains, France	Project Management

Architecture that cares

Materials were carefully selected to meet safety, durability and ease of maintenance requirements. In addition to their environmental qualities, they also create a warm ambience, notably by leaving the wood exposed in certain rooms.

Particular attention is also paid to patients' spatial cues. The creation of a sensory signage plan on every floor means that children of all ages can find their bearings and feel safe, and can easily reproduce the route to their unit by touch.



A landscape for living, a garden for caring



Conceived as a veritable garden of sensations, the outdoor space offers a wealth of opportunities for play and discovery based on touch, taste and smell. The landscape also supports a “tableau” function, which can be contemplated from the windows. The idea is to integrate symbolic elements from the surrounding landscape and reproduce them on a smaller scale in the themed gardens. In this way, a whole universe of imagination and discovery is offered to children around the mountain, nature and market gardening.

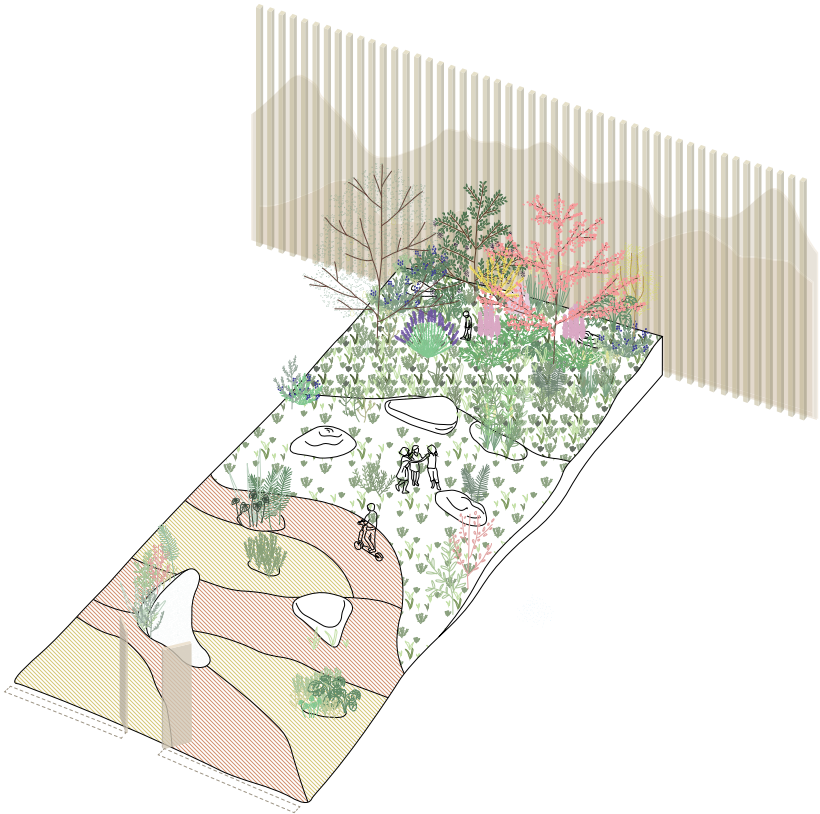

Offering patients an environment dedicated to awakening their senses, to stimulate their curiosity and imagination about the landscape around them.

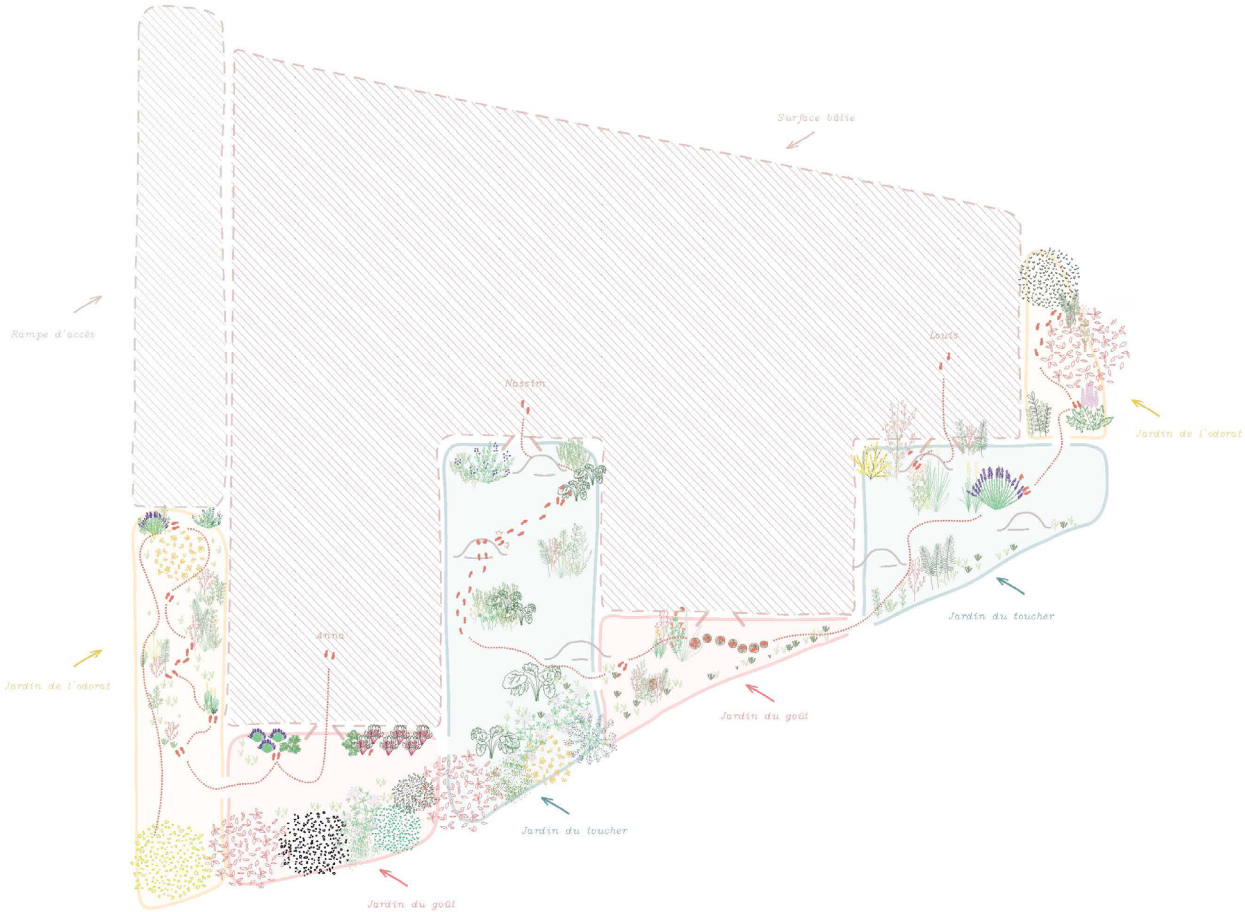



EPSM

Typology	Construction cost	Status
Health	5.7 M€	On going
GFA	Location	Mode of assignment
2 172 m²	Thonon-les-bains, France	Project Management