

Specialized Care Home

Construction of a 50-bed specialized care home.

CLIENT

La Rochelle Hospital Center

TEAM

Patriarche (Architecture, Interior Design, Landscaping, Environmental Quality, BIM, Engineering, All Trades, Cost Management, Graphics, Signage)
Credits: 3D Renderings: © Patriarche

KEYPOINTS

Clear organization
Protected gardens
Wooden framework
Consideration of disability-specific needs

SUSTAINABILITY

Durable materials.
Adjustable sunshades.
Low-carbon design.
RE2020 compliant.
Solar thermal panels.

Designed to accommodate adults with multiple disabilities or profound mental impairments combined with motor, sensory, or somatic disabilities, the Specialized Care Home (MAS) “La Fontaine du Roc” was conceived to meet the specific needs of its residents, forming their living environment.

At the heart of the project: clarity of pathways, to help residents find their way, orient themselves, and move around easily and intuitively.

Organized around a central garden and a communal hall resembling a village square, the project unfolds into small houses where the bedrooms are located.



Typology	Construction cost	Status
Healthcare	7.6 M€	Ongoing
GFA	Location	Project delivery
3 680 m²	La Rochelle, France	MOP Law

Design Intentions – Conceptual Approach

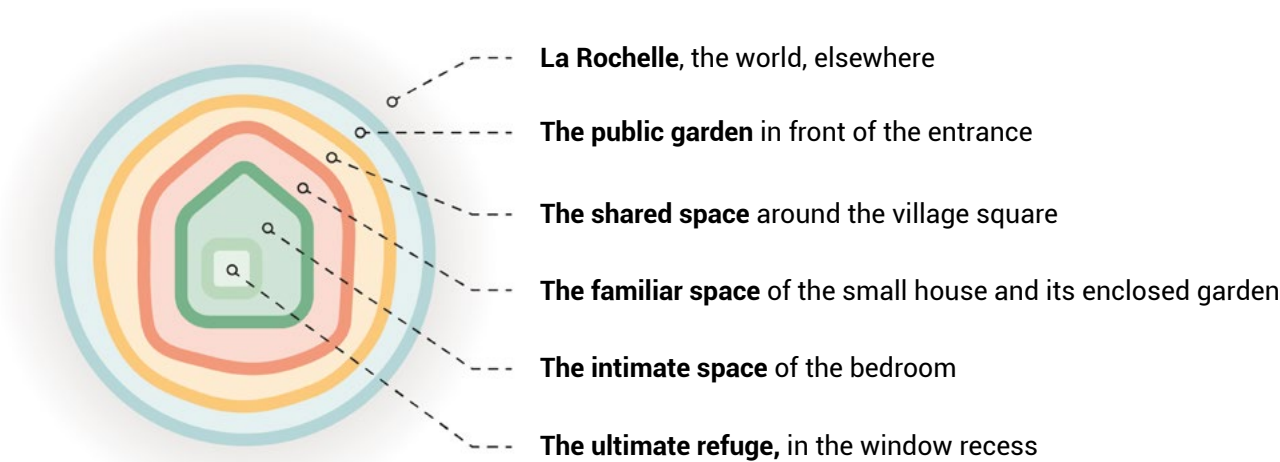

We have designed a reassuring, containing environment, conducive to social interaction while also offering retreat spaces, protective refuges, so that residents can always feel comfortable in their living space.

From Intimacy to Community

Inside each house, as well as in the shared spaces, a wide variety of paths and areas are available to residents. The paths form loops where one cannot get lost: wherever you are, clear landmarks help you orient yourself, and you are always led back to your starting point.

Along these paths, alcoves allow residents to isolate themselves, while other spaces of various types and sizes encourage interaction. Play areas, gardening boxes, small lounges, and terraces punctuate the walking paths, inviting rest and shared activities.



- RECEPTION - ACTIVITIES
- PARAMEDICAL AND EDUCATIONAL FUNCTIONS
- STAFF AREAS
- LOGISTICS
- LIVING UNITS 1+2 / 3+4 / 5
- TECHNICAL AREAS

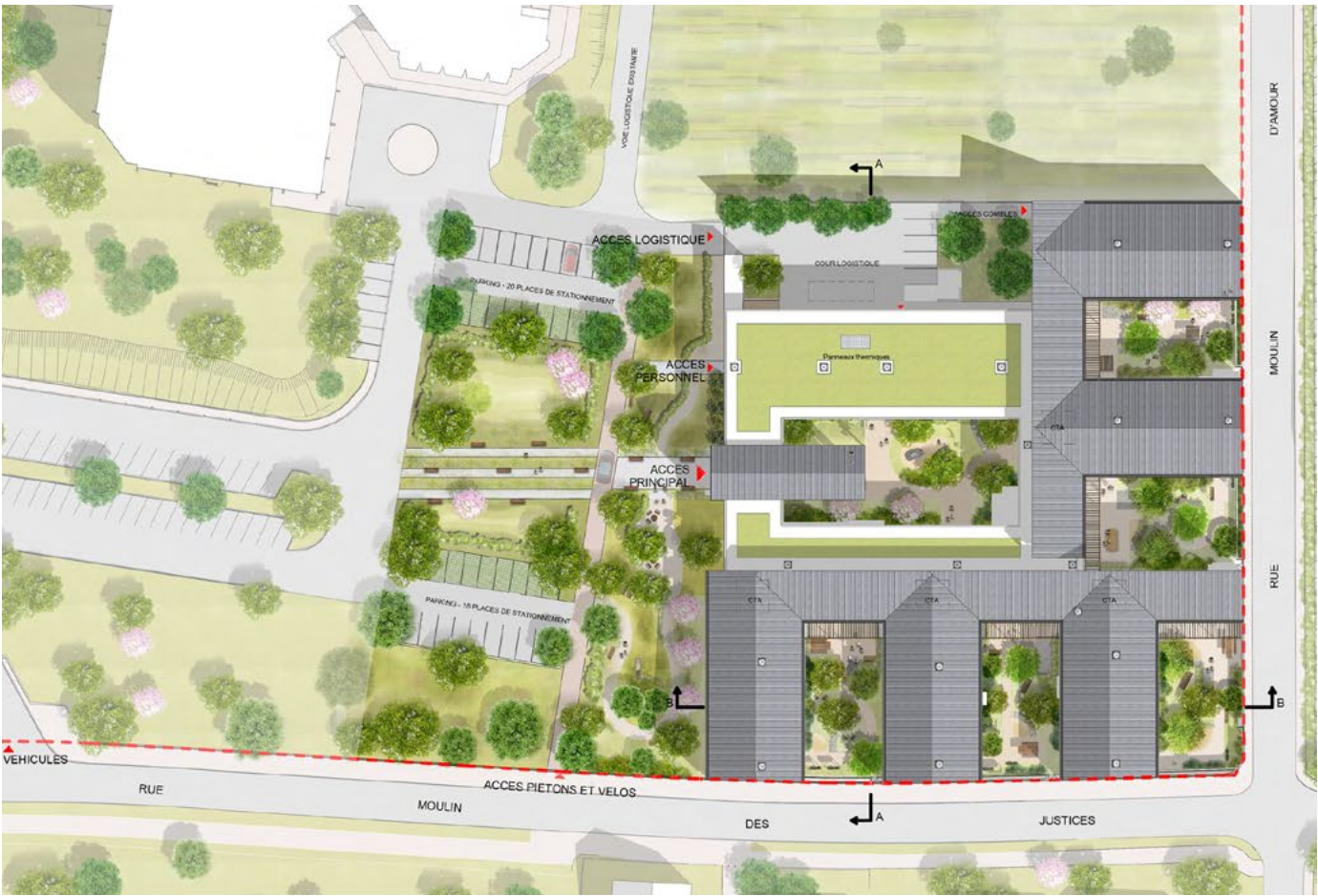

The gardens

The gardens – private gardens for each house, a shared central garden, and a public garden in front of the entrance – allow residents to enjoy the sun, seek shade, or find shelter depending on the weather. Safety is ensured throughout: there are no blind spots, people are always nearby, and surveillance from surrounding spaces is constant.



The small houses

The rooms are distributed among small houses, each identified by a specific decorative treatment. Entry is through a living room with a high ceiling and zenithal lighting. The bedrooms are grouped in a quiet wing, ending in a small lounge that opens onto a sheltered outdoor terrace. Residents can move around the houses, from bedrooms to living areas, either indoors or outdoors.



Specialized Care Home

Typology	Construction cost	Status
Healthcare	7.6 M€	Ongoing
GFA	Location	Project delivery
3 680 m²	La Rochelle, France	MOP Law