

Rescue center

Construction of a Rescue Center and functional housing for the Paris Fire Brigade and their families.

CLIENT

Seine-Saint-Denis Police Prefecture

TEAM

Plan2 (Lead Architect)

Patriarche (Architecture)

Partners :

Elcimai, Terrell, Gamba, Terrell, Vision-

Architekturexport

Credits :

3D Perspectives : Plan2

KEYPOINTS

Wooden structure.

CLT flooring.

Straw insulation.

Green roof.

SUSTAINABILITY

Compliance with the NF Habitat HQE label -

Excellent Sustainable Passport (Housing).

Certification HQE BD 2016 (Rescue Center).

Connection to the district heating network.

Energy recovery from greywater.

Rainwater harvesting and reuse.

Photovoltaic production.

To the west of Paris, at the foot of Mont Valérien, the city of Rueil-Malmaison is aligning with the Grand Paris initiative. In the residential and small collective housing areas that primarily occupy the northern part of the commune, the arrival of the Line 15 station presents an opportunity for urban renewal and the creation of a new centrality.

The fire station project seamlessly integrates into this new neighborhood, composed of fairly dense blocks and a large pedestrian greenway, a living space that prioritizes soft mobility and structures the city.

The steep slope of the terrain guided the architectural intent, allowing the project to take advantage of this constraint. Thus, at the corners of the two streets, at the lowest point of the site, the project volumes rise and form, through their architectural interplay, a significant landmark for the fire station, marking the entrance to the ZAC.

The program, comprising two distinct entities — the fire station and the housing — forms a compact and homogeneous ensemble. The training yard, developed at the lower part of the slope, helps to distance the fire station from residential areas.



Typology	Construction cost	Status
Equipment	19,2 M€	Delivered in 2025
GFA	Location	Nature of the contract
7 000 sqm	Rueil-Malmaison, France	Design mandate (public sector)

Environmental intentions

The fire station stands out for its ambition in terms of environmental quality. The housing for BSPP executives is designed with a wooden structure, using post-and-beam construction and CLT flooring. The facades are made of timber framing and insulated with bio-sourced straw bales. This project represents a real technical challenge, requiring an experimental technical assessment (Atex).

The building complies with NF Habitat HQE standards for housing and HQE Sustainable Building standards for the fire station. Its envelope is carefully designed to minimize thermal losses, thanks to extra insulation, triple glazing, and individualized air handling units for each dwelling.

The volumes that make up the entire project flow harmoniously, forming a distinct architectural and environmental unity.

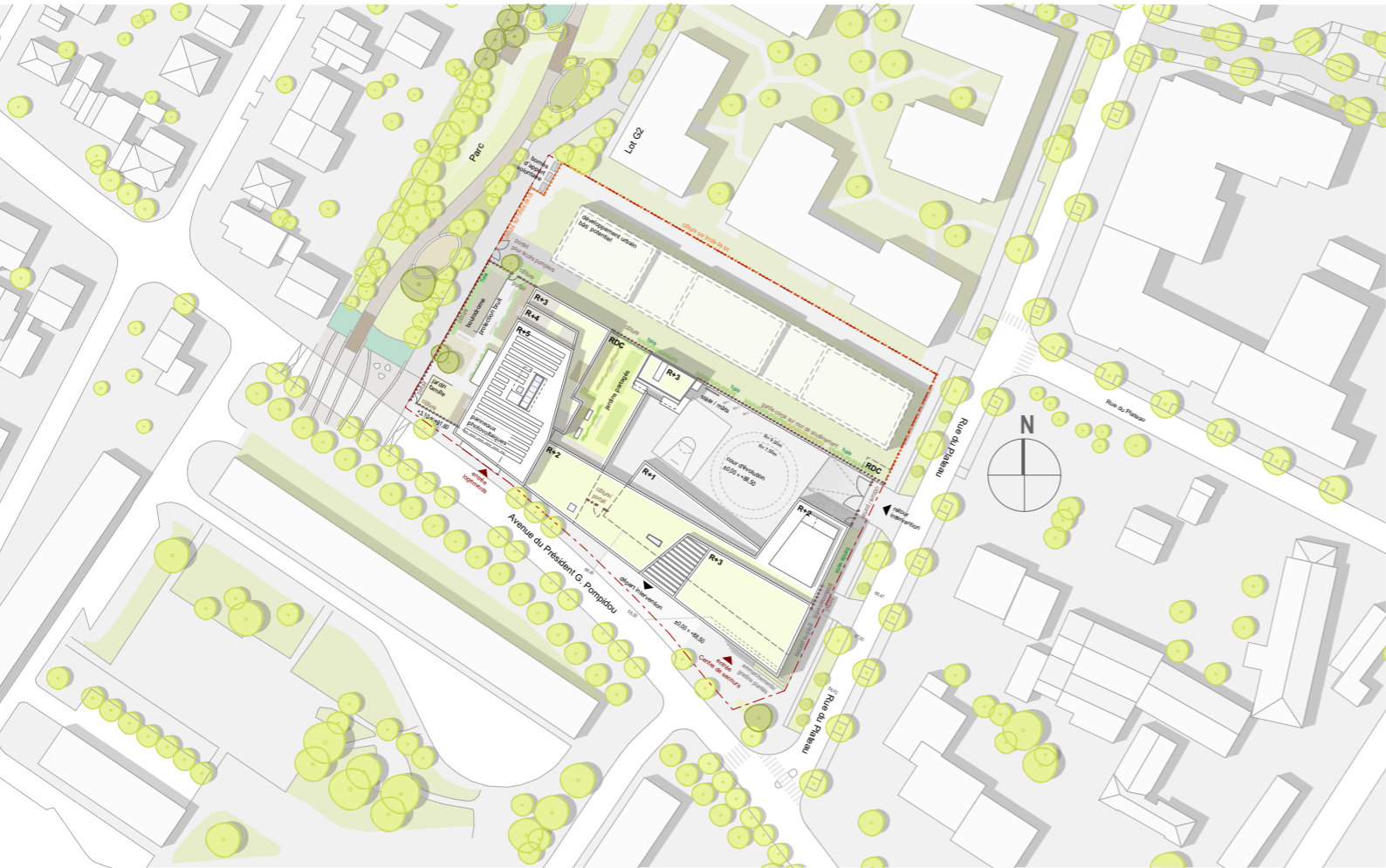

The project also includes energy recovery from greywater. Additionally, rainwater is collected to supply the sanitary facilities and clean the rescue vehicles.

The roofs of the housing units are equipped with a photovoltaic plant, producing part of the energy self-consumed by the project.

This project, reflecting a sustainable approach, achieves the C1 carbon level of the E+C- experiment.



Rescue center

Typology	Construction cost	Status
Equipment	19,2 M€	Delivered in 2025
GFA	Location	Nature of the contract
7 000 sqm	Rueil-Malmaison, France	Design mandate (public sector)