

Orange Bamako

Construction of the new headquarters bringing together all the group's activities in a single, innovative location.

CLIENT

Orange

TEAM

Patriarche (Architecture)
Partners :
Ardi Architecture (Architecture),
Projex (TCE & OPC Engineering)

KEYPOINTS

Architecture respectful of its context.
Minimalist composition and structure.
A new landmark in the heart of Bamako.
NWow.
High-rise building (HRB).

Showcasing the group's modernity and ambition, Orange's new regional headquarters stands as a symbol of the company's influence in Bamako.

Located in the heart of the emerging business district of ACI 2000, this ambitious project—comprising office floors spread across 14 levels—is designed to bring together all the group's activities in a single location. Its volume makes it a strong landmark, reflecting the region's development and enhancing its appeal.

Made up of three buildings forming a unified whole, the project reveals an architectural design based on balance. The slenderness of the towers combined with the variety of proposed heights creates a bold project that nonetheless blends into its surroundings.

Typology	Construction cost	Status
Offices	N/C	In process
GFA	Location	Project delivery
15 600 m²	Bamako, Mali	Private project management



A sober and bold architecture

Both spectacular and simple, the building's pronounced vertical structure is especially reflected in the façade design: it asserts the identity of a building that embodies the transformation of the district it integrates into.

Made of fixed vertical metallic fins, the façade features a color treatment in soft gold tones, harmonizing perfectly with the interior architecture's material palette, which plays with warm shades reminiscent of copper, gold, and precious wood. The metallic fins are almost entirely matte, preventing any risk of glare while generously redirecting light into the interior spaces.

A project designed to address climate challenges

Striking a true balance between aesthetics, elegance, and architectural prowess, the façade also serves as an effective response to the region's significant climate challenges. Oriented at a 45° angle to the façade, the fins' positioning helps shield the interior spaces from nearly all direct solar radiation throughout the day. This greatly enhances comfort, the quality of workspaces, and the building's energy efficiency.



Open spaces connected to the outdoors

Fully integrated into its surroundings, the project features various spaces that open to the outside. Its large openings, combined with its R+13 height, offer wide views of the district and the surrounding city. The overall volume also reveals spacious terraces located on levels 5 and 9, providing users with genuine relaxation areas connected to the outdoors.

Designed as a green filter, the building's forecourt aims to create a buffer between the structure and the avenue, helping to reduce urban noise. The landscaped surroundings of the building also offer additional benefits: the planting of trees and shrubs enables natural thermal regulation—essential in this tropical climate—and improves air quality and ambient oxygen levels.

Flexibility, scalability, and user comfort.

NWow – Flexible and Scalable Workspaces

Designed with maximum freedom, the layout of the office floors aims to create spaces suited to today's needs and adaptable to those of tomorrow. This approach encourages the development of flexible layouts that can accommodate various types of activities, while giving employees the freedom to choose where they want to work and how to arrange their workspace. The spaces are designed to foster a culture of exchange and collaborative working methods.

To enable this, the building's design —both architectural and technical— is intended to be simple and efficient. The central tower of the project houses the main core, which organizes vertical circulation. The two other towers each have a secondary core to simplify the flow across the floors.

The horizontal circulation shared by the different towers acts as a link between the various spaces. The possibility of creating multiple access points allows for an ultra-flexible and scalable layout. The floor dedicated to hosting the General Management and Deputy General Management features a different configuration from the others: it is arranged as a private office space and includes a terrace with an unobstructed, panoramic view of the Malian capital.

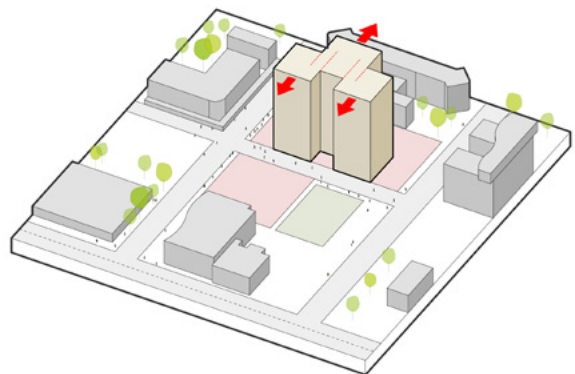
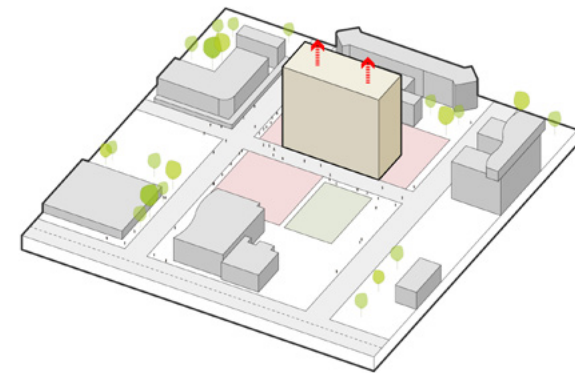

An optimized distribution of shared spaces

From the site entrance to the workspaces, all pedestrian flows are regulated and designed to facilitate movement between different users. Directly connected to the site's main access, the reception hall extends over a generous double height, offering an open space for the various services available. Waiting areas are arranged around a central reception desk that directs incoming flows.

Designed with user comfort in mind, the project includes numerous shared spaces:

- A company restaurant: simple and functional, this essential living space also features a landscaped outdoor area.
- Two fitness rooms: located at the heart of the project, these two exercise spaces are oriented toward the outdoor football field and are bathed in natural light to offer users a pleasant workout environment.
- Wellness spaces: set back from the main areas, these rooms have their own patios and discreet, quick access to the outside to preserve the privacy required for such spaces.
- General services: located near vertical circulation, technical rooms, and exterior access points, these security and logistics areas are treated more independently, away from other ground-floor services.



Orange Bamako

Typology	Construction cost	Status
Offices	N/C	In process
GFA	Location	Project delivery
15 600 m²	Bamako, Mali	Private project management