

Outdoor center

Construction of a new reception pavilion at the outdoor center in Sainte-Foy.

CLIENT

Quebec city

TEAM

Patriarche (Architecture, Signage)

Partners:

FNX Innov et WSP, Stantec, and Drolet Construction, Art Massif

Credits:

Photos: © Stéphane Groleau

KEYPOINTS

Wood construction.

Traditional and contemporary architecture.

Exterior design.

AWARDS

Prix d'excellence de l'Ordre des Architectes du Québec.

Prix d'excellence CECOBOIS.

Mérite d'architecture de la Ville de Québec (Community – New Build category winner).

Grands Prix du Design - Projet «OR».

The City of Quebec's program for this new pavilion comprises four buildings, housing administrative, public, sanitary and storage functions. The aim of the project is to enhance this natural site in the heart of urban life and give it a strong identity.

This single-storey division also makes it easier to control access to the building for each type of use, both for the public and for the pavilion's employees. By recessing the facades, gaps are created between the buildings, allowing the creation of viable, protected outdoor spaces.

Open to the general public, it was essential that the pavilion's materials be durable and easy to maintain, in order to extend its useful life and minimize operating costs.

Finally, we worked closely with our engineers to design a highly energy-efficient building.



Typology
Sport, Culture

Surface area
2,288 m²

Construction cost
6.8 M\$CAD

Location
Sainte-Foy, Canada

Status
Delivered in 2019

Allocation mode
Private project management

Intentions

The concept for the new reception pavilion at the Base de Plein Air de Sainte-Foy is defined by its scale, in keeping with the site and landscape. The architectural solution developed for this new building is simple, almost vernacular, yet fundamentally contemporary.

Initially, the City of Quebec planned to construct a single 2-storey building. By splitting the program into several buildings (all connected), the team was able to make the whole on a human scale, allowing users to develop a close relationship with the site and the activities on offer. This configuration also favors links with the outside world, allowing the building to blend into the site with a more ethereal effect. This project is definitely the result of good spatial organization and a judicious choice of materials.

The challenge for the site was to use the pavilion to showcase this extraordinary green site nestled in the heart of urban life.

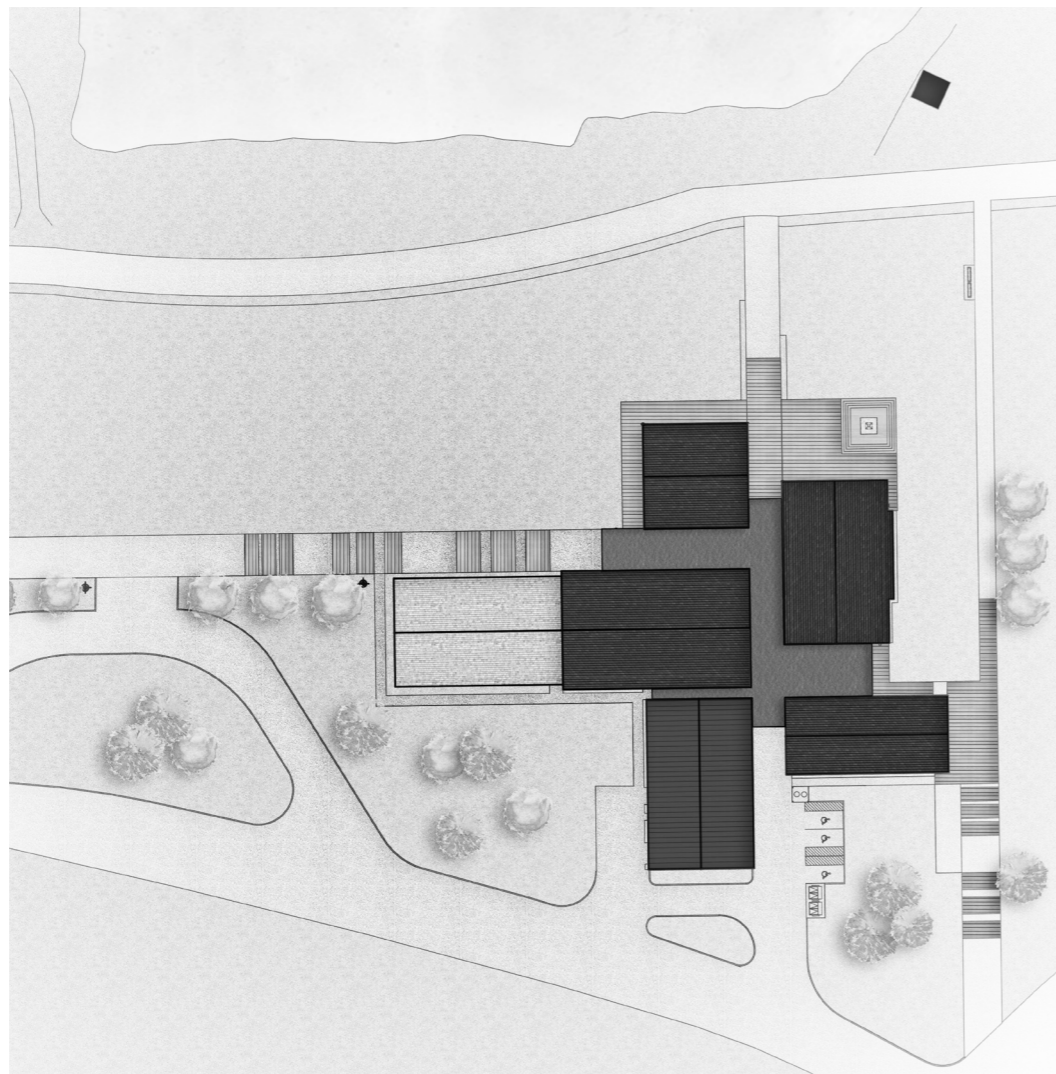
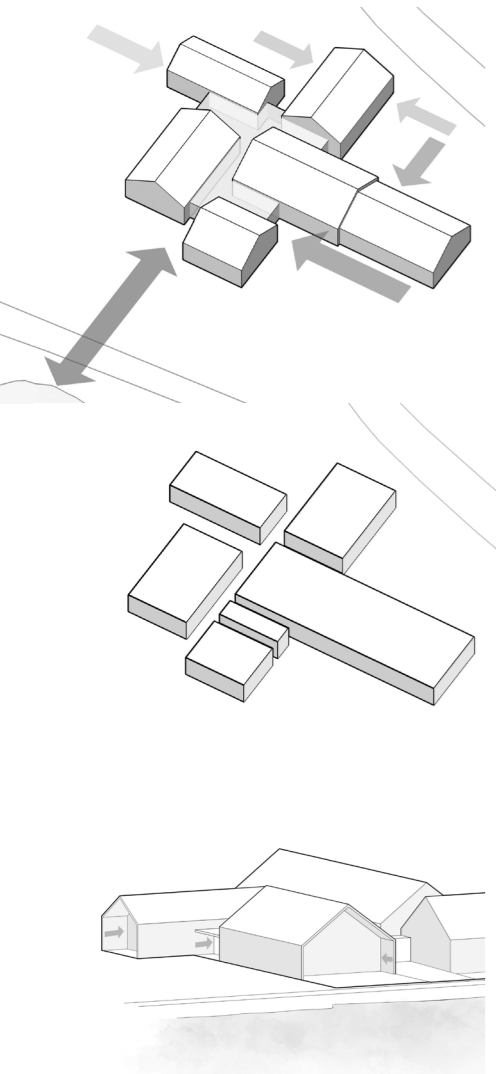

Materials were chosen primarily for their rustic, natural appearance, in keeping with the site's Nordic landscape, but also for their durability and ease of maintenance.

- Materials:
- + Cedar shingles
 - + Slate shingles
 - + Cedar clapboard
 - + Steel sheet

Wood - a noble, durable material

The use of wood was an obvious choice right from the design stage. Firstly, the division of the building's functions into several single-storey pavilions, topped by pitched roofs, naturally led the design team to consider a timber structure with traditional trusses, simplifying the building's construction and keeping costs down. The multi-purpose hall features a glued-laminated timber structure, with exposed timber decking. This lends a warm, natural look to the gathering space, in keeping with the vocation of the outdoor venue. What's more, this choice fits perfectly with the objectives of integrating the reception pavilion into its surroundings, by using a natural material present in the immediate wooded environment of the outdoor base.



Wood has been used in a number of ways inside the building, with the aim of extending the site's natural outdoor environment into the building's interior.





Outdoor center

Typology
Sport, Culture

Surface area
2,288 m²

Construction cost
6.8 M\$CAD

Location
Sainte-Foy, Canada

Status
Delivered in 2019

Allocation mode
Private project management
