

Clinic, Metz

Merging of two private clinics into a warm, aesthetic and peaceful space.

CLIENT

Elsan Group

TEAM

Patriarche (architecture, interior design, ingenierie, general construction, cost assessment, landscape, urban planning, High Environmental Quality [HEQ] standards, and BIM, digital)
Partners: OTE Ingénierie, Gamba, Hospi Coach, Adopale, and Convergence
Credits:
3D pictures: ©Patriarche

KEYPOINTS

Scalability.
Smart Hospital.
A hospital district urban design.
Prefabrication and modular construction.

ENVIRONMENTAL PERFORMANCE

Optimisation of energy consumption.
Biodiversity.
Healthy materials.
Rainwater harvesting.
Photovoltaic farm.
Water-saving equipment.
Reduction of carbon impact.
rainwater recovery.

When designing this 380-bed clinic of the future, Patriarche focused on the search for physical and emotional well-being while caring for the patient from the time they leave home until they return.

The proposed new architecture places the individual at the heart of the building, given a human and domestic scale to help reduce stress and anxiety.

The first leg of the journey starts with 'The maison' ('The house'), a building with a welcoming architecture with glass walls. Designed to be the clinic's beating heart, where any sign of being a hospital has been removed, it houses shops, restaurants, digital information points, and various specialist consultation rooms.

Outpatient and hospital care are located in the building called the 'hotel' where pathways have been designed to have soothing surroundings and continuous views of nature in so-called 'green rooms'. Nature's healing effect is the common thread running through the sensory experiences where the patient's independence is encouraged.

The hospital technical facilities are in the third building, where building access and connections have been designed to optimise movement through the building and to foster excellence in care by healthcare staff.

The digital technology offering enhances the architecture by allowing more patient independence and well-being through applications developed by Patriarche UX.



Typology	Construction cost	Status
Health	100 M€	Competition 2020
Surface area	Location	Allocation mode
35 000 m²	Metz, France	Private project management

Intentions – Standpoint

The clinic is organized around three buildings, each with complementary functions and a distinct atmosphere.

“The House” brings together reception and dining areas: this is where patients arrive, wait, and enjoy leisure activities. The layout and ambiance are designed to be warm and welcoming, encouraging interaction and connection.

“The Hotel” houses the medicalized rooms, conceived as cozy and reassuring cocoons. It also includes consultation spaces and laboratories.

“The Platform” is dedicated to operating rooms and emergency services. It is designed to ensure optimal flow and maximum efficiency in movement and work processes.

The spatial arrangement of these three entities allows part of the clinic to be “de-hospitalized,” offering a stress-free zone for patients and integrating the medical facility into the urban fabric. Colors, materials, lighting, and furniture reinterpret hospitality design codes.

The clinic is structured around three buildings, each with complementary functions and a distinct atmosphere.

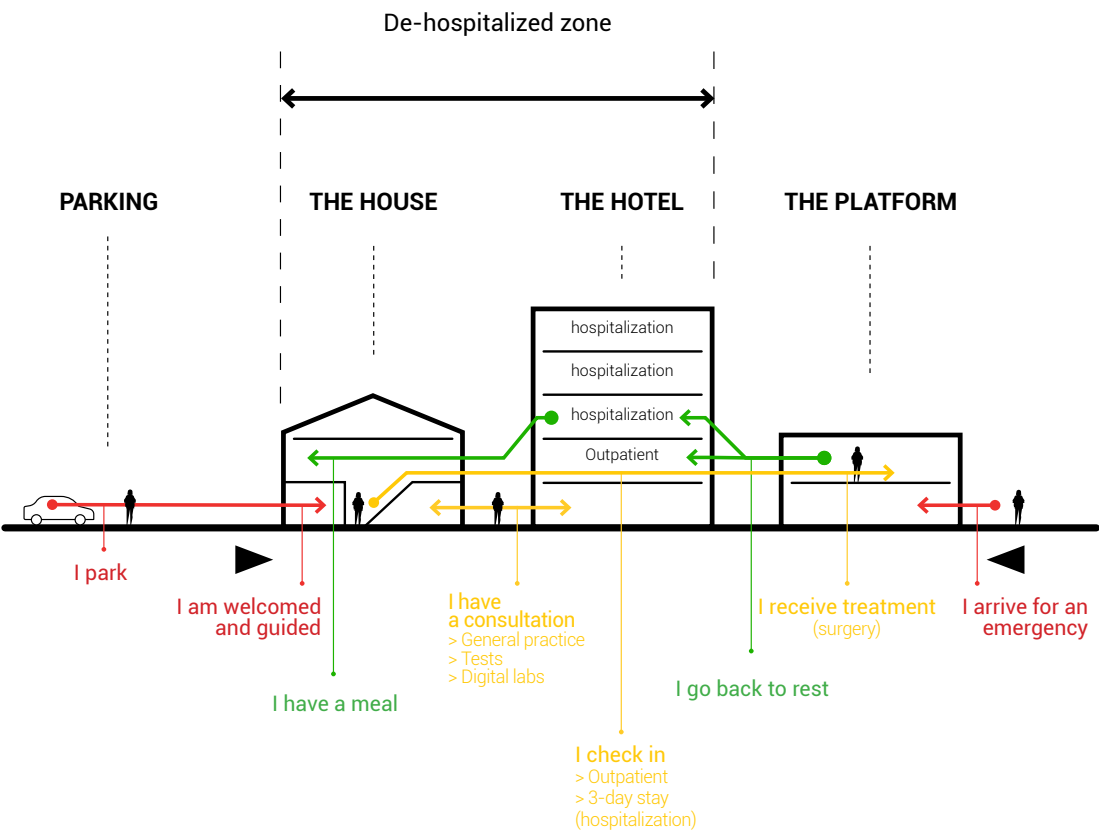

Urban and landscape concept



A fragmented health urbanism, better integrated into the city and at a human scale
Comfortable transition spaces to reduce stress
A direct encounter between the patient and nature

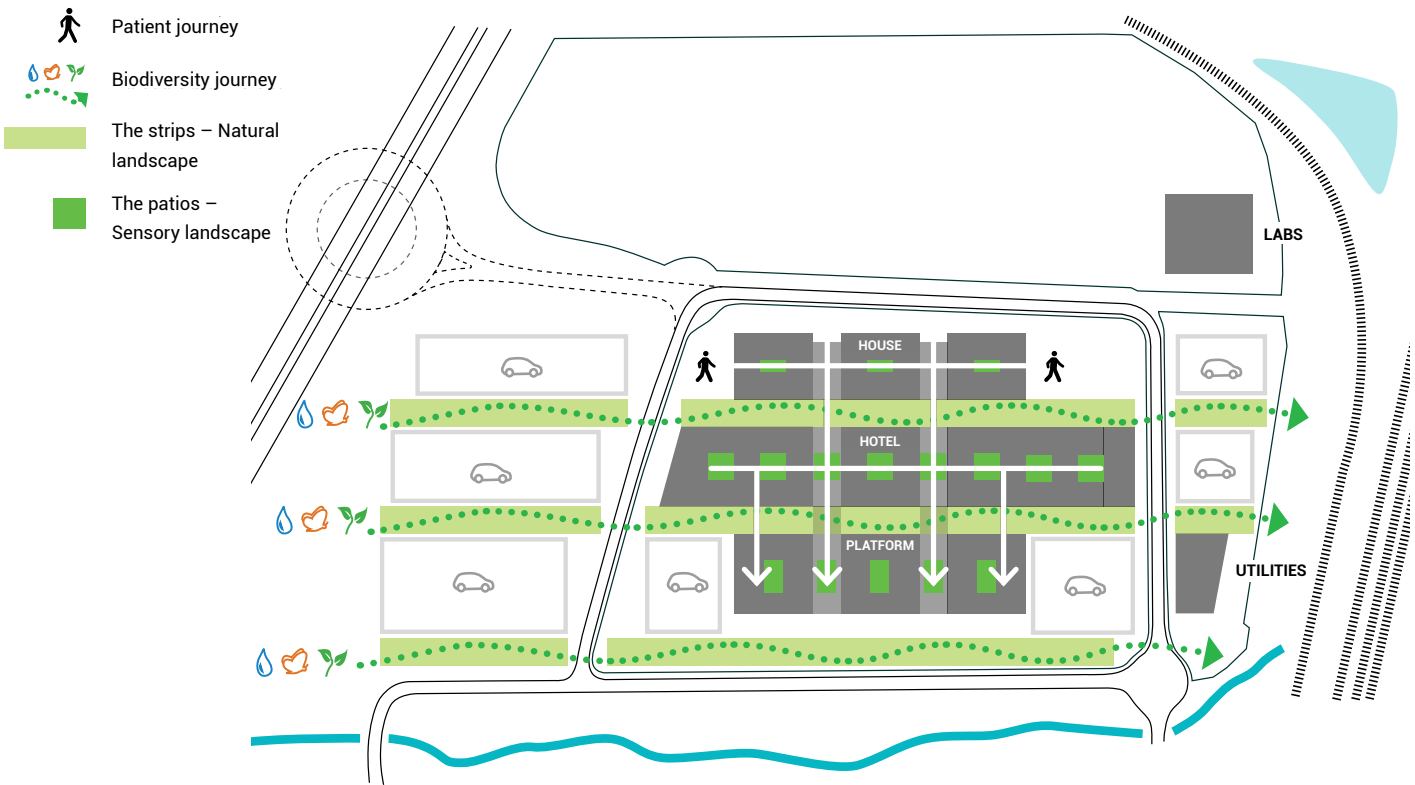

Smart Building and Digitalization

An intelligent and connected clinic where people remain at the heart of digital innovation.

- The digitalization of the clinic is based on the following systems:
- No.1: The Building Operating System – BOS
 - No.2: A multi-service controller system with indoor geolocation
 - No.3: A connected and scalable security system
 - No.4: Full connectivity

Smart Hospital

To achieve the 3-star level of the “Ready 2 Service” standard from the Smart Building Alliance, integrating a BOS is essential. It is a platform where all building systems exchange structured data—among themselves and with future service applications. Indoor geolocation (Wi-Fi terminals, Bluetooth beacons), multi-service controllers (lighting, HVAC, blinds), and sensors (presence, brightness...) make life easier for all users. Self check-in, buzzers, touch terminals, and directional guidance help streamline the patient’s arrival.



Technologies Considered

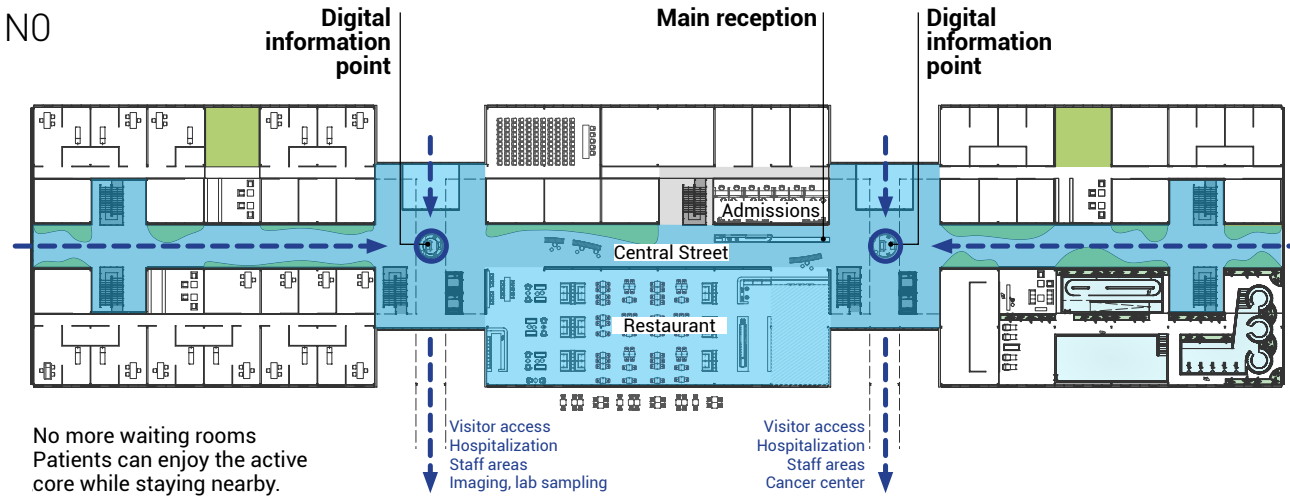
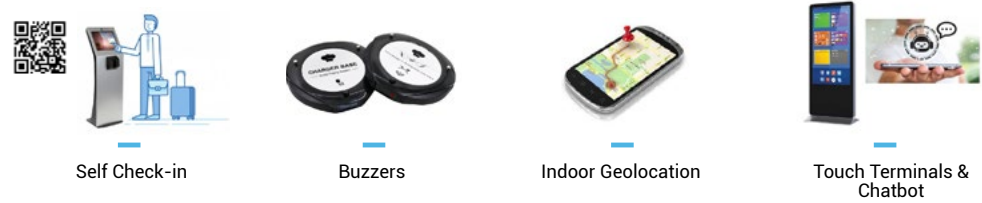

Digital building revolution

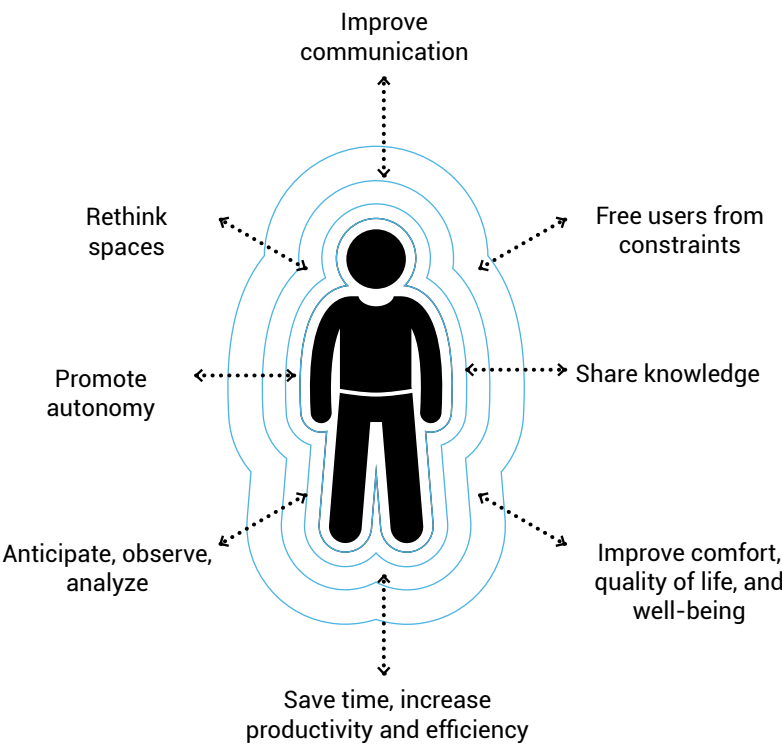
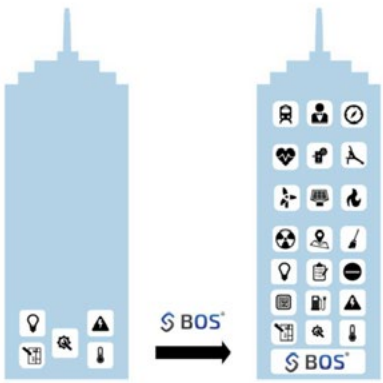

Technologies Considered

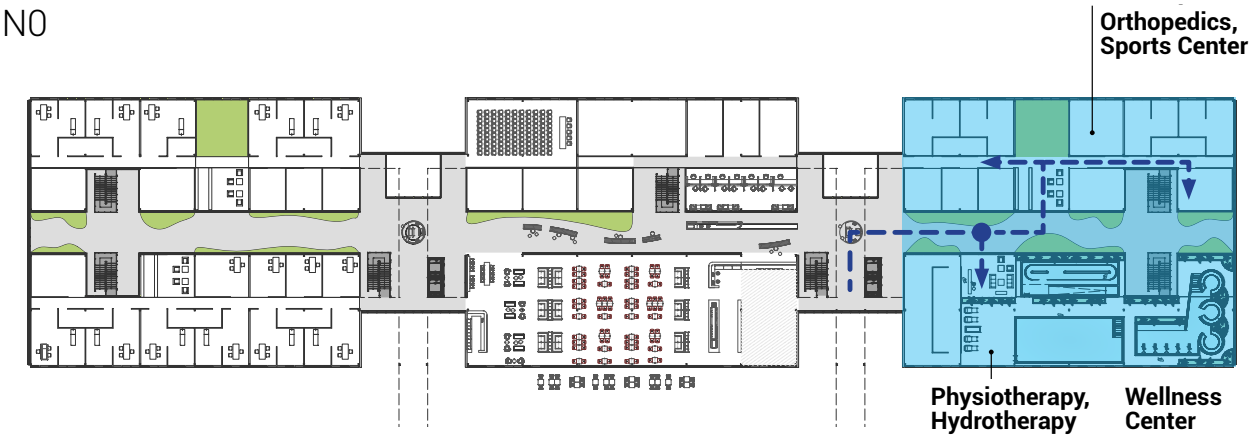

Sustainable Design and Resilience

A construction capable of adapting to change, evolving toward new uses, or responding to a pandemic crisis.

Scalability

At the site level, the buildings are positioned to allow for various extensions.^[2]
At the building level, the structural grid, open floor plans, and column/slab system allow for flexible spatial configurations.^[1]

Circular Economy

By prioritizing prefabrication, modular construction, and working with local companies, the project puts circular economy principles into practice.

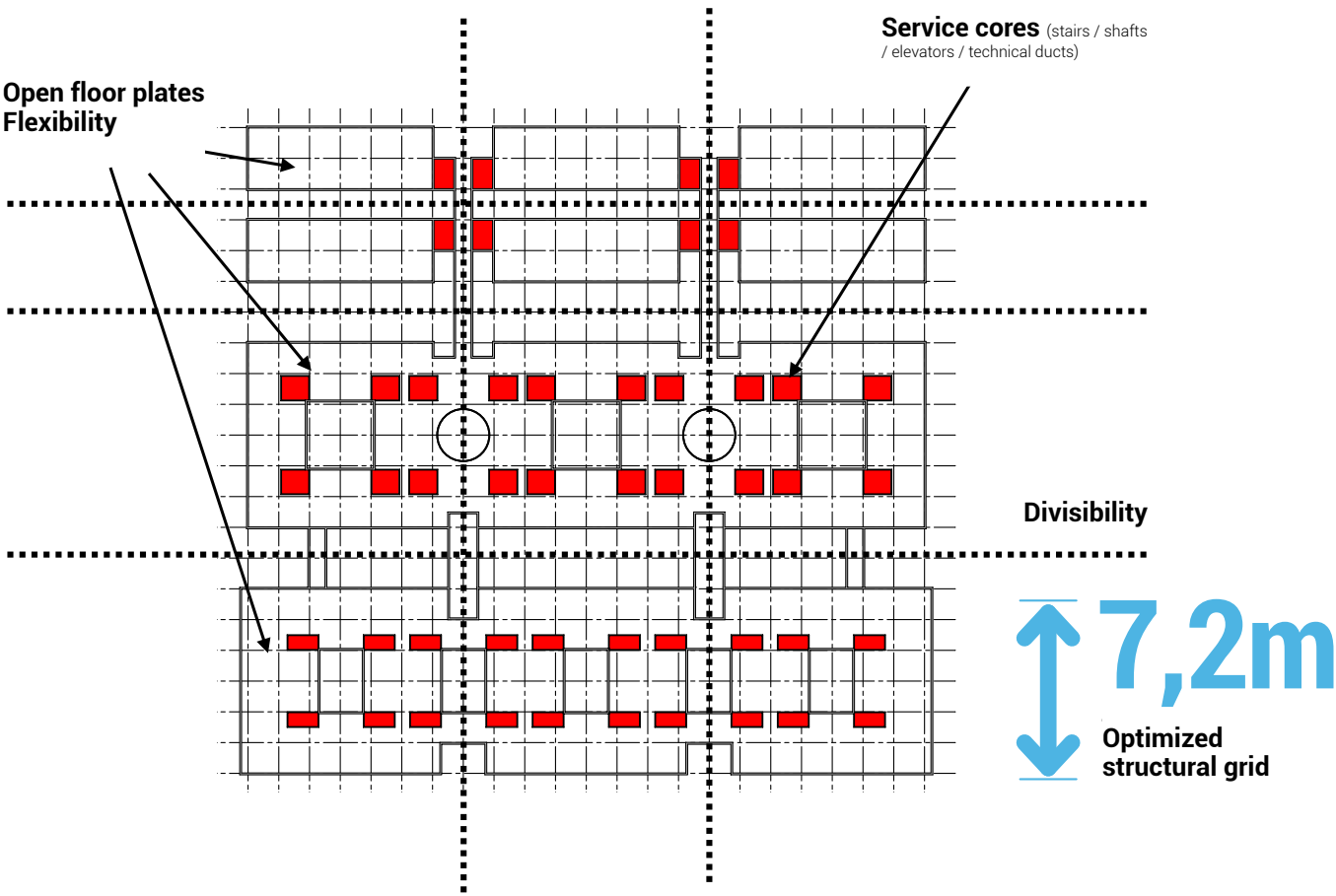

QEB Evaluation Grid

ENERGY

GENIUS OF THE PLACE Context / Environment / Ecology / Sociology / Local economic impacts

BIOCLIMATIC DESIGN Local climate / Winds / Sun exposure / Façade treatment / Solar optimization / Natural ventilation

ENERGY EFFICIENCY Sizing of heating, domestic hot water (DHW), and air conditioning systems

WATER EFFICIENCY Water-saving equipment / Rainwater harvesting

CARBON

CONSTRUCTION METHOD Off-site prefabrication (timber structure)

SECONDARY MATERIALS Bio-based coatings and insulation (bio-based secondary work)

CIRCULAR ECONOMY Reuse through local supply chains (green construction reuse)

RESILIENCE

HEALTH AND WELL-BEING Indoor air quality, Active and passive methods to improve thermal/hygrometric comfort

RISKS Climatic, Natural, Health-related, Technological

ADAPTABILITY Modularity, Reversibility, Flexibility

BIODIVERSITY Greening of façades/ roofs/landscaping of the site





Clinic, Metz

Typology	Construction cost	Status
Health	100 M€	Competition 2020
Surface area	Location	Allocation mode
35 000 m²	Metz, France	Private project management